



1620 Sunflower Way, Johnstown, CO 80534

Community: Granary **Floor Plan:** Clemens

\$511,360

2,288 Finished Sq Ft. 3 Bedrooms 2.5 Full Baths 2 Car Garage 2.0 Stories



****MOVE-IN READY!****

Introducing the Clemens, a stunningly spacious home that combines contemporary elegance with thoughtful design. This floorplan includes 3 sizeable bedrooms, 2 and a half bathrooms, and a large loft that offers endless possibilities for use. The expansive yard provides ample space for outdoor enjoyment with your pup and hosting guests for a grill-out. The Clemens offers a fresh, vibrant setting for your next chapter.

This home is finished with White painted cabinets, Home Chef Gas Appliance package, Marina (marble-look) quartz throughout, Ryman (neutral) vinyl plank flooring, Matte Black door levers & faucets. **This home backs and sides to open space!**

Photos are of the actual home!

CALL 970-716-6088 TO SCHEDULE A 1 ON 1 APPOINTMENT

Plans and elevations are artist's renderings only, may not accurately represent the actual condition of a home as constructed, and may contain options which are not standard on all models. We reserve the right to make changes to these floor plans, specifications, and elevations without prior notice. Stated dimensions and square footage are approximate and should not be used as representation of the home's precise or actual size.



1620 Sunflower Way, Johnstown, CO 80534

Community: Granary Floor Plan: Clemens

\$511,360

2,288 Finished Sq Ft. 3 Bedrooms 2.5 Full Baths 2 Car Garage 2.0 Stories

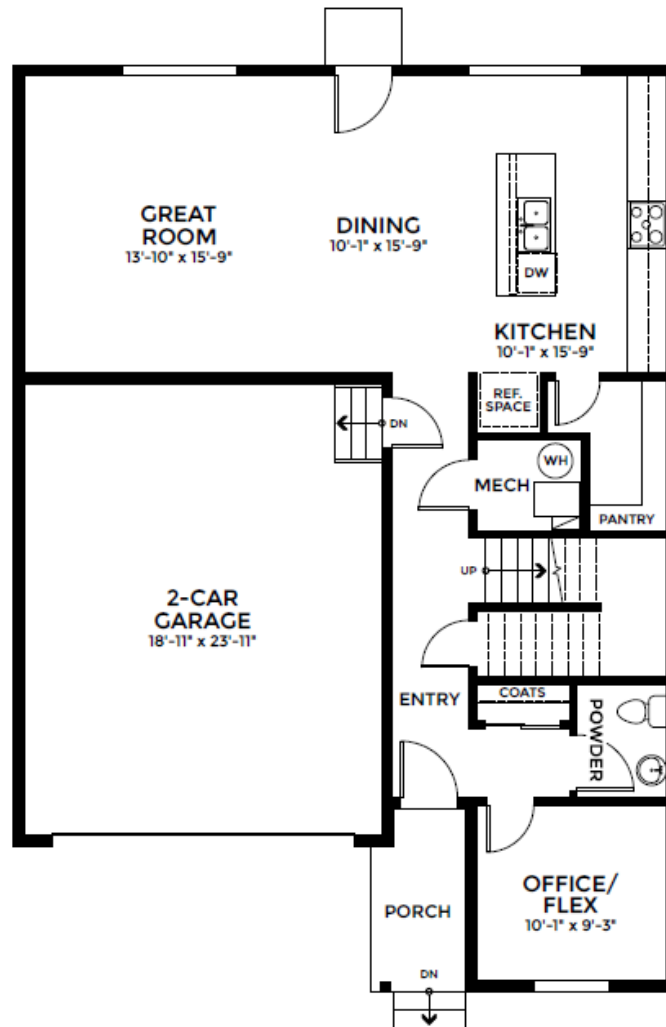

FIRST FLOOR

CALL 970-716-6088 TO SCHEDULE A 1 ON 1 APPOINTMENT

Plans and elevations are artist's renderings only, may not accurately represent the actual condition of a home as constructed, and may contain options which are not standard on all models. We reserve the right to make changes to these floor plans, specifications, and elevations without prior notice. Stated dimensions and square footage are approximate and should not be used as representation of the home's precise or actual size.